

---

# USER MANUAL

**MODEL NUMBER:  
FOAM CART - 15 GALLONS**

**Portable Electric Foam Cart for Multiple  
Applications**

---

**English (Original Instructions)**

---

## READ ALL INSTRUCTIONS BEFORE OPERATING EQUIPMENT



### WARNING



#### Read this manual completely and understand the machine before operating or servicing it.

- Read all instructions before installing or operating unit.
- Always wear appropriate personal protective equipment (PPE) when operating or servicing unit.
- Always follow all chemical safety precautions and handling instructions provided by the chemical manufacturer and Safety Data Sheet (SDS).
- If this unit is modified or serviced with parts not listed in this manual, the unit may not operate correctly.
- Never point the discharge wand at yourself, another person, or any object you do not want covered in chemical.
- Always depressurize unit after use (as described in the After Use Instructions). Always store unit depressurized, with the discharge valve in the closed position.
- Do not exceed an air pressure of 80 psi (5.5 bar).
- Do not exceed a fluid temperature of 100°F (37°C).
- Always flush the unit with fresh water for 5 minutes when switching from an alkaline to an acid or an acid to an alkaline.
- Never use unit with hydrocarbons or flammable products.
- Before performing any maintenance on this unit, disconnect the unit from the electrical power source and depressurize it as described in the After Use Instructions.

#### PROTECT THE ENVIRONMENT

Please dispose of packaging materials, old machine components, and hazardous fluids in an environmentally safe way according to local waste disposal regulations.



Always remember to recycle.

\*Specifications and parts are subject to change without notice.



### WARNING

#### COMPRESSOR

- Use caution when filling the unit with water or solution. **DO NOT** spill water or solution on the compressor when filling the unit.

## READ ALL INSTRUCTIONS BEFORE OPERATING EQUIPMENT

<b>REQUIREMENTS</b>	
Liquid temperature range	40-100°F (4.4-37°C)
Electrical requirements	120 VAC at 60 Hz, 10 amps (GFCI protected outlet)
Operating voltage	120 VAC
Operating air pressure	80 psi (5.5 bar)
Chemical compatibility	Chemical products used with this equipment must be formulated for this type of application and compatible with unit materials and pump seals. For more information on chemical compatibility, consult the manufacturer or SDS for your product or contact our customer service department.

<b>SPECIFICATIONS</b>	
Power type	Electricity
Chemical pickup type	Draws from pre-mixed solution
Number of products unit can draw from	One product
Suction line diameter	3/8 in. (9.5 mm) inside diameter
Capacity	15 gallons (56.78 liters)
Discharge hose diameter/length	100 ft. (30.5 m) twin-line tubing, with 1/4 in. (6.4 mm) outside diameter
Discharge wand/tip type	Polypropylene trigger handle with 50° fan tip
Output distance	4-6 feet (1.2-1.8 m)
Output volume	6 gal/min (22.7 l/min) of foam
Flow rate*	1 gal/min (3.8 l/min)
Pump seals	Santoprene
Wheel type	Two 10 inch non-marking wheels, Two 5 inch casters with lock

\*Flow rates given are based on chemical with viscosity of water and factory air pressure settings.

## READ ALL INSTRUCTIONS BEFORE OPERATING EQUIPMENT

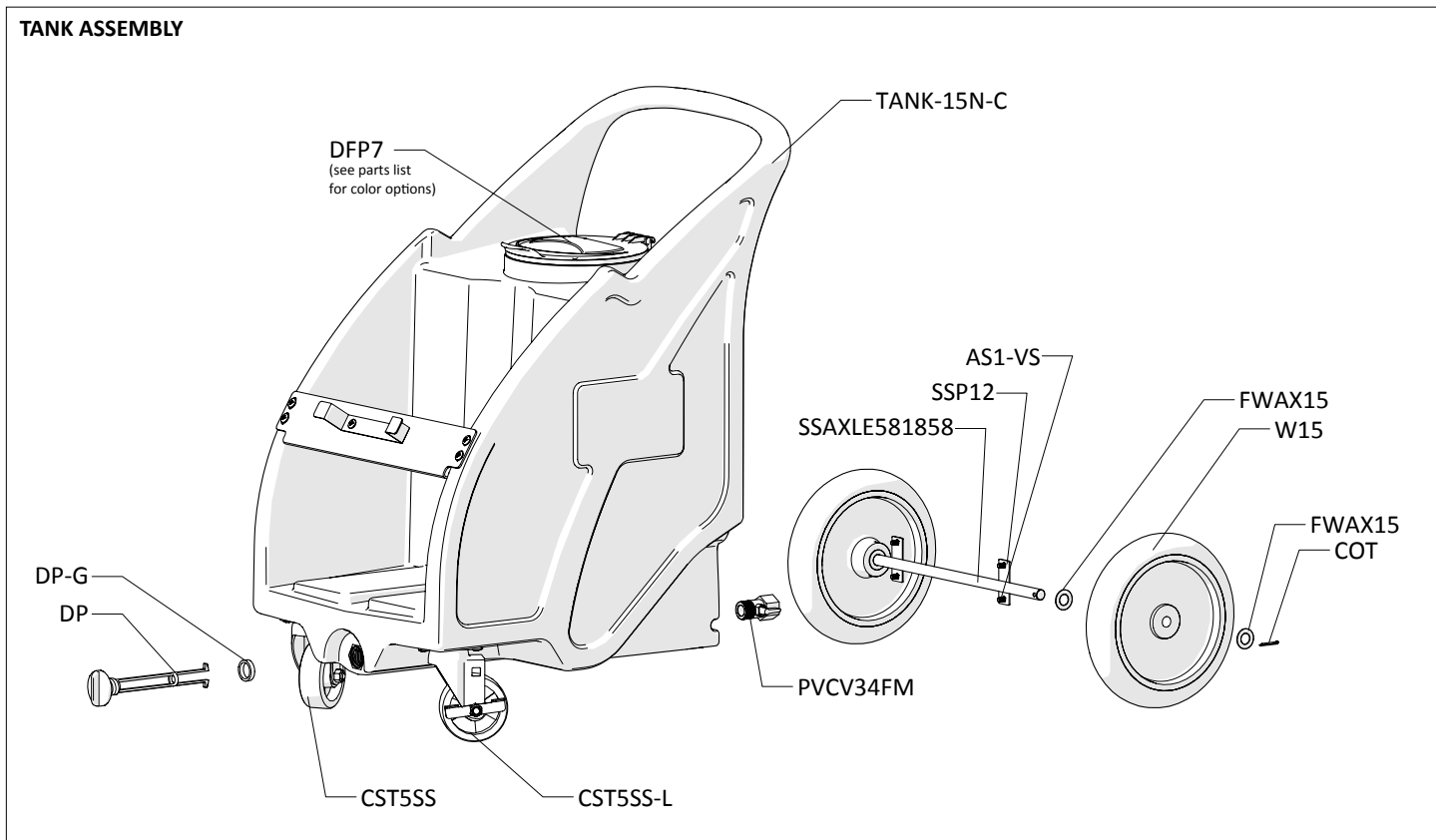

## READ ALL INSTRUCTIONS BEFORE OPERATING EQUIPMENT

### BACK PLATE INSIDE

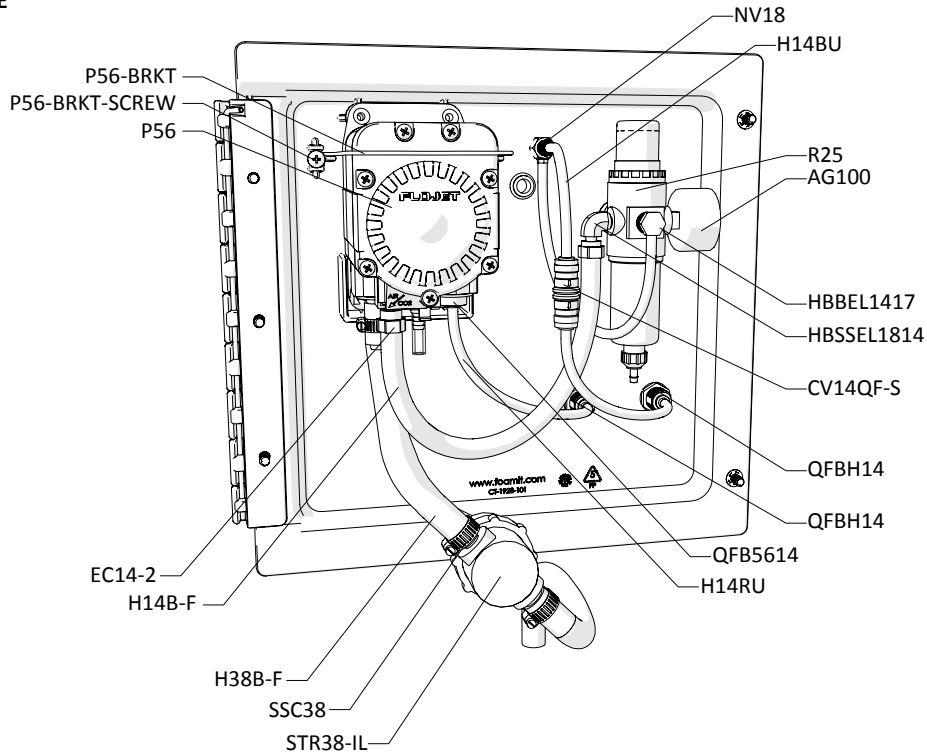

### BACK PLATE OUTSIDE

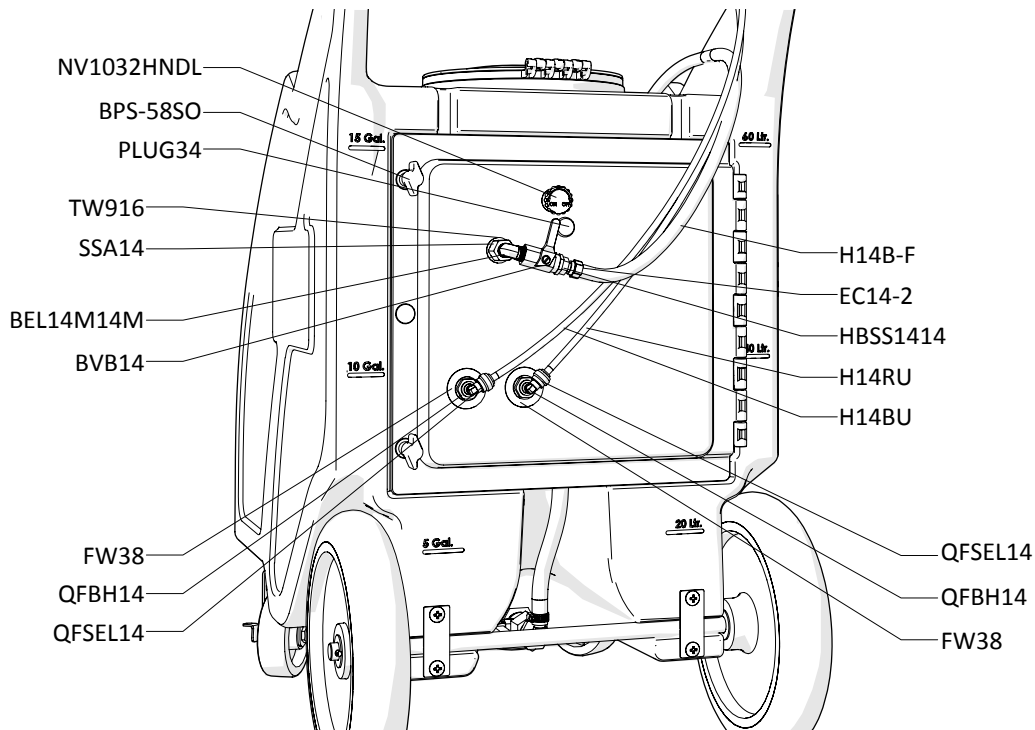

# READ ALL INSTRUCTIONS BEFORE OPERATING EQUIPMENT

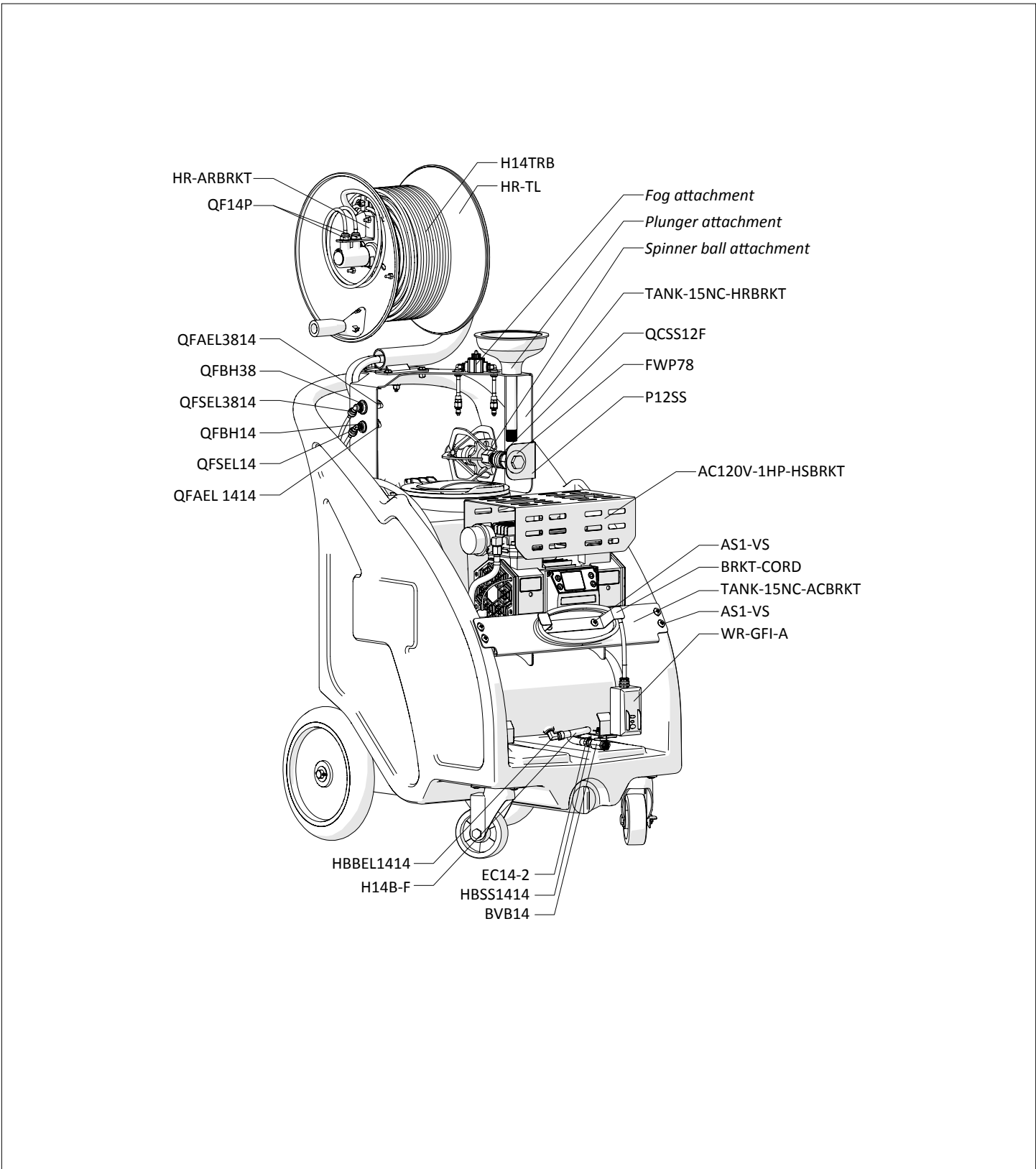

**READ ALL INSTRUCTIONS BEFORE OPERATING EQUIPMENT**

**DISCHARGE ASSEMBLY  
ITEM NUMBER: SGA-APF**

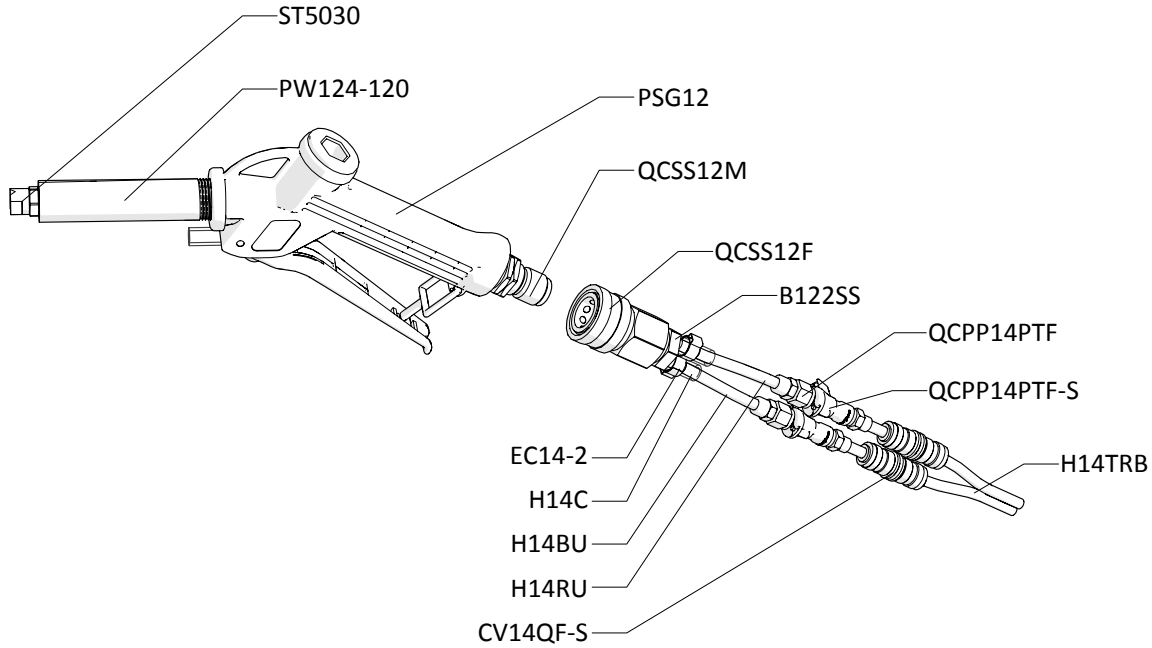

**FOAM SPINNER BALL  
ITEM NUMBER: FSB-APF**

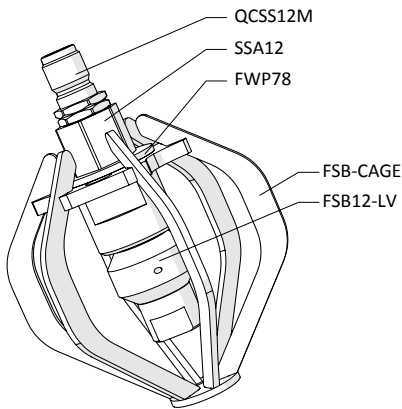

**FOG NOZZLE ASSEMBLY  
ITEM NUMBER: FNA-APF**

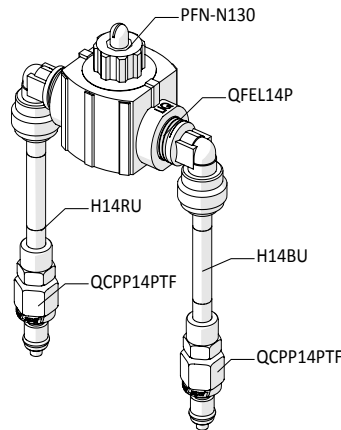

**DRAIN PLUNGER ATTACHMENT  
ITEM NUMBER: DPA-6**

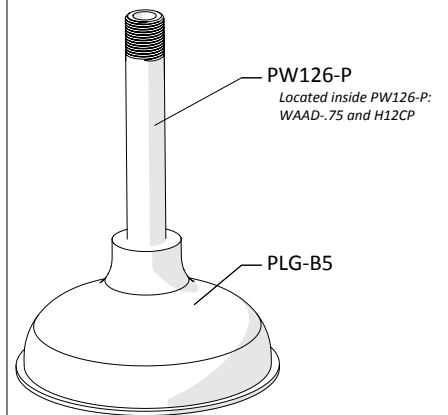

## READ ALL INSTRUCTIONS BEFORE OPERATING EQUIPMENT

### Assembly Instructions:

1. Remove all components from packaging.
2. Attach hose reel (HR-TL) to the bracket (TANK-15NC-HRBRKT) and handle using hardware provided.
  - a. Secure the hose reel with a bolt, washers (FW14), and lock nut (LN14) in each hole.
  - b. Use the longer bolts (B14202) to attach the hose reel to the handle. Use the shorter bolts (B142058) for the remaining holes
  - c. Attach red and green hoses from the hose reel to quick fittings. Green hose attaches to the top fitting (QFBH38) and the red hose attaches to the bottom fitting (QFBH14).
3. Install the compressor (AC120V-1HP) on the front of the unit using the hardware provided.
  - a. Set compressor and pre-assembled bracket in the cavity. Insert the screws (AS1-VS) into the bracket (TANK-15NC-ACBRKT) and secure to inserts on the sides of the tank.
  - b. Attach the blue air hose to the hose barb (HBSS1414) on the back plate. Secure the hose to the barb with the provided screw band clamp.

### Operation Instructions:

1. Follow all instructions from chemical manufacturer. Fill the tank with with ready-to-use or mix to chemical manufacturer instructions. DO NOT spill solution on the compressor.
2. Plug the unit in to a 120 VAC power outlet.
3. Turn the power switch ON to start the air compressor. Set the pressure setting to 0.60 MPa (85 psi)
4. With the discharge valve (PSG12) in the closed position, open the air inlet valve (BVB14).
5. Point the discharge wand in a safe direction and open the discharge valve (PSG12) to begin foaming. The discharge valve (PSG12) should be completely open while foaming.
6. While the unit is running and discharging product, adjust the needle valve (black knob - NV1032HNDL), located on the back plate, to regulate the wetness or dryness of the foam:
  - a. Close needle valve completely in clockwise direction.
  - b. Open needle valve in counter-clockwise direction 2 complete turns.
  - c. Continue to open needle valve in ¼ turn increments, allowing 30 seconds between adjustments, until desired consistency of foam is achieved.
7. To stop foaming, close the discharge valve (PSG12).

### Attachment Operation Instructions:

The quick-connect fittings allow for easy change between attachments for different applications. Always depressurize the

discharge line before switching attachments.

**PLUNGER ATTACHMENT:** This is a great attachment for the dirty and smelly drains.

1. Remove the plunger attachment (DPA-6) from the bracket.
2. Unthread the wand (PW124-120) from the discharge valve (PSG12). The wand can be stored on the bracket. Be careful that the gasket (PSGORV) does not fall out of the discharge valve outlet.
3. Thread the plunger attachment to the outlet of the discharge valve.
4. Place on top of a drain without removing the drain cover. Open the discharge valve to start foaming. To stop foaming, close the discharge valve.

**MISTING ATTACHMENT:** This attachment can be used to deodorize trash rooms, loading docks, etc. To deodorize a trash compactor, open the compactor flue and the natural draft will suck the mist up and deodorize from the bottom to the top. Note: Before changing to the misting attachment, shut off the air supply to the unit by closing the air inlet valve (BVB14) and open the discharge valve (PSG12) to relieve any pressure remaining in the unit. Close the discharge valve (PSG12) after all pressure has been relieved from the unit.

1. Disconnect the quick connect plugs (QCPP14PTF) from the sockets (QCPP14PTF-S).
2. Connect the quick connect plugs from the misting attachment to the sockets.
3. Open the air inlet valve (BVB14) to begin misting.
4. To stop misting, close the air inlet valve (BVB).

**SPINNER BALL ATTACHMENT:** This attachment is for use to foam trash chutes. The attachment will coat the inside of the trash chute and backs of chute doors.

Note: Before changing to the spinner ball attachment, shut off the air supply to the unit by closing the air inlet valve (BVB14) and open the discharge valve (PSG12) to relieve any pressure remaining in the unit. Close the discharge valve (PSG12) after all pressure has been relieved from the unit.

1. Disconnect the stainless quick connect plug (QCSS12M) and coupler (QCSS12F).
2. Run tubing through the T-BAR and connect the stainless quick connect on the spinner ball attachment (QCSS12M) to the coupler (QCSS12F).
3. Rest the T-BAR on the trash chute door and avoid dragging the spinner ball against the side of the trash chute. Slowly lower the spinner ball attachment to the bottom of the trash chute.
4. Open the air inlet valve (BVB14) to begin foaming.
5. Slowly pull the spinner ball attachment to the top of the trash chute.



## READ ALL INSTRUCTIONS BEFORE OPERATING EQUIPMENT

6. To stop foaming, close the air inlet valve (BVB14).

### After Use Instructions:

1. With the unit running, open the discharge valve (PSG12), and allow the unit to be flushed with fresh water for approximately 2-4 minutes or until all chemical has been discharged from the system.
2. Shut off the air supply to the unit by closing the air inlet valve (BVB14).
3. Turn the power switch OFF to shut off the air compressor.
4. Open the discharge valve (PSG12) to relieve any pressure remaining in the unit.
5. Close the discharge valve (PSG12) after all pressure has been relieved from the unit. Store the unit with the discharge valve (PSG12) in the closed position.
6. Unplug the unit from the power outlet.
7. Depressurize and drain the air compressor tank. Draining the compressor tank after each use helps extend pump life. An air source with a high moisture content will accelerate pump wear.

### Maintenance Instructions:

To keep the unit operating properly, periodically perform the following maintenance procedures:

Note: Before performing any maintenance, disconnect the unit from the electrical power source and depressurize it as described in the After Use Instructions.

- Inspect the pump (P56/P56K/P56V) for wear and leaks.
- Inspect all hoses and tubing for leaks or excessive wear. Make sure all hose clamps and push-fittings are in good condition and properly secured.
- Check the chemical suction line and strainer (STR38-IL) for debris and clean as needed.

### Troubleshooting Instructions:

- Check the discharge tubing to ensure that there are no kinks that could obstruct fluid flow.
- If the needle valve (NV18) is open too far, the pump (P56) may cycle improperly due to lack of air pressure. This can cause sporadic foam. If this occurs, close and readjust the needle valve as described in the Operation Instructions.
- Check for proper air pressure on the air gauge and adjust the air regulator if needed. The air regulator is factory set at 80 psi (5.5 bar). Operating pressure is 80 psi (5.5 bar).
- Check the chemical suction line and strainer for debris or damage. Clean or replace as needed. To prevent damage to the unit, the strainer (STR38-IL) must always be used.
- Make sure proper foaming chemical and concentration are being used.

- If air passes through the pump (P56) without cycling, the pump needs to be replaced.
- If foam comes out wet, no matter where the needle valve (NV18) is positioned, the wadding (WAAD-.75) inside the discharge wand your dilution may be too lean or you may need to be replaced. To change the wadding:
  - a. Unthread the wand (PW124-120) from the trigger handle (PSG12).
  - b. Remove the old wadding (WAAD-.75) from inside the wand.
  - c. Check that the spacer tubing (H38CP) is positioned inside the wand (PW124-120). If the spacer tubing is missing or damaged, remove it and insert a new piece.
  - d. Insert two new pieces of wadding (WAAD-.75) into the wand.
  - e. Check that the gasket (PSGORV) is positioned inside the trigger handle (PSG12). If the gasket is missing or damaged, remove it and insert a new gasket.
  - f. Thread the wand (PW124-120) back into the trigger handle (PSG12).
- If foam comes out wet, no matter where the needle valve (NV18) is positioned, and the wadding (WAAD-.75) is in good condition, the check valve (CV14QF-S) may need to be replaced.
- If solution backs up into the air regulator, the check valve (CV14QF-S) needs to be replaced.

## READ ALL INSTRUCTIONS BEFORE OPERATING EQUIPMENT

ITEM NUMBER	DESCRIPTION
AC120V-1HP	120V AIR COMPRESSOR - 1HP
AC120V-1HP-HSBRKT	HEAT SHIELD FOR AIR COMPRESSOR
AG100	1.5 INCH DRY MODEL 20 DUAL SCALE GAUGE
AS1-VS	1/4-20 X 1/2 PHIL TRUSS MACH SCREW 19-8 W/516 ORANGE VIBRASEAL PATCH
B122SS	1/2in S.S. MALE BY TWIN .170 BARB
B14202	HEX HEAD BOLT-1/4IN-20 THREADS-2 IN LONG
B142058	HEX HEAD BOLT-1/4IN-20 THREADS-5/8IN LONG
B8X58	8-15 x 1/2 FLAT PHIL TY-A 18-8 PLN
BEL14M14M	ELBOW 1/4in MPT X 1/4in MPT
BPS-58SO	Back Panel Screw - 5/8 inch with Stand Off
BPS-SSR	1/4 INCH PUSHNUT BOLT RETAINER STAINLESS STEEL
BRKT-CORD	CORD WRAP BRACKET - PAINTED
BSB-RMFT	EPDM FEET FOR -WB UNITS
BVB14	AIR INLET VALVE - VA BRS 025-4F4F-BT, NICKEL
COT	1/8 X 1 COTTER PIN 18-8 S/S
CR112PVC	1-1/2 INCH PVC CROSS - BLACK
CST5SS	5in S.S. SWIVEL CASTER WITH 4 IN WHEEL
CST5SS-L	5in S.S. SWIVEL CASTER WITH 4 IN WHEEL AND LOCK
CV14QF-S	1/4 TUBE X 1/4 TUBE CHK QUICK FIT-SMALL
DFF7	7 INCH HINGED CAP ASSEMBLY - INCLUDES BLACK CAP, LID FLANGE AND HINGE PIN
<i>DFF7-C</i>	7 INCH FILL CAP POLYETHYLENE BLACK
<i>DFF7-F</i>	7 INCH TANK LID FLANGE POLYETHYLENE
<i>DFF7-PIN</i>	HINGE PIN FOR 7 INCH FILL CAP AND FLANGE
DP-A	DRAIN PLUG ASSEMBLY FOR NATURAL PORTABLE UNITS - INCLUDES PLUG AND GASKET
<i>DP</i>	FRONT DRAIN PLUG FOR PORTABLE UNIT POLYETHYLENE
<i>DP-G</i>	FKM LATHE CUT 60 DUROMETER
EC14-2	OETIKER CLAMP 13.8
EC18	OETIKER CLAMP - 11.3
FSB-CAGE	FOAM SPINNER BALL CAGE
FSB-MANDREL	FOAM SPINNER BALL - MANDREL
FSB-NUT	FOAM SPINNER BALL -- RETAINING NUT
FSB-SB-LV	FOAM SPINNER BALL ONLY -- FOR TWIN LINE OR LOW VOLUME APPLICATIONS
FW14	1/4 X 5/8 OD FLAT WASHER 18-8 PLN
FW38	.687 ID X 1-1/2 OD X .07 TK FLATWASHER (5/8) 18-8
FWAX15	FLAT AXLE WASHER
FWP78	7/8in BY .137 BY 1 1/4in FLATWASHER 18-8 PLN
H12CP	1/2IN OD POLYETHYLENE TUBING - NATURAL COLOR

H14B-F	1/4 INCH BLUE HOSE-HYBRID TPE-Available per ft.
H14BP	1/4IN OD POLYETHYLENE TUBING - BLUE
H14BU	1/4in OD BLUE POLYURETHANE TUBING - Available per ft.
H14C	1/4in ID CLEAR POLYVINYL TUBING - Available per ft. (3/8 in OD)
H14RP	1/4IN OD POLYETHYLENE TUBING - RED
H14RU	1/4in OD RED POLYURETHANE TUBING - Available per ft.
H14TRB	1/4in RED/BLUE POLYURETHANE TWIN TUBE
H38B-F	3/8 INCH BLUE HOSE-HYBRID TPE-Available per ft.
H38CP	3/8 IN OD POLYETHYLENE TUBING - NATURAL - Available per ft.
HBB103217	HOSE BARB 10-32 MPT X B4 FITTING
HBBEL1417	HOSE BARB 1/4 MPT X .17 BARB ELBOW
HBEL1414	HOSE BARB ELBOW 1/4 X 1/4
HBSS1414	STAINLESS HOSE BARB 1/4 MPT X 1/4 BARB
HBSSEL1438	STAINLESS HOSE BARB 1/4 MPT X 3/8 BARB ELBOW
HBSSEL1814	STAINLESS HOSE BARB 1/8 MPT X 1/4 BARB ELBOW
HHPB3414	HEX HEAD POLY BUSHING 3/4 MPT X 1/4 FPT
HR-ARBRKT	SS ANTI-ROTATION BRACKET FOR HOSE REEL
HR-TL	HOSE REEL FOR TWIN LINE HOSE - NO HOSE INCLUDED
LN12PVC	1/2IN PVC LOCKNUT
LN14	1/4-20 NE NYL INS LOCKNUT 18-8 PLN
NV1032HNDL	BLACK HANDLE FOR NEEDLE VALVE
NV1032SETS	SET SCREW FOR HANDLE
NV18	NV2SV-B,6.5T DS,1/8M,10-32F-VALVE ONLY-NO SETS-NO HANDLE
P12SS	HEX HEAD PLUG - 1/2 IN. MPT - SS304
P56	PUMP WITH SANTOPRENE SEALS - INCLUDES HOSE BARBS, AIR FITTING, AND EXHAUST BARB
P56-BRKT	PUMP BRACKET- STAINLESS STEEL
P56-BRKT-SCREW	HI LO SCREW FOR RETAINING P56-BRKT
PFN-N130	PNEUMATIC FOG NOZZLE - POLYPROPYLENE AND KYNAR TIP - 3.7 GAL/HR PER NOZZLE
PLG-B5	DRAIN PLUNGER - BLACK W/ 5in DIAMETER - 6 PACK
PLPF	PORTABLE FOAMER BACK PLATE W/ HINGE AND HOLES
PLPF-PIN	302 STAINLESS PORTABLE PLATE HINGE PIN
PLUG34	TUBING PLUG 3/4 ( FITS 11/16 HOLE)
PSG12-P	1/2 IN POLY SPRAY GUN W/ GRAY HANDLE & 316SS
PSGORV	PSG12 O RING-VITON
PVC112S40	1-1/2 in PVC-40 PIPE - WHITE
PVCV34FM	PVC VALVE 3/4in FPT X 3/4in MPT

## READ ALL INSTRUCTIONS BEFORE OPERATING EQUIPMENT

PW124-120	1/2IN MPT X 1/4IN FPT-4IN LONG-BLACK POLYPRO
PW126-P	1/2IN MPT X 1/2IN MPT-6IN LONG-BLACK POLYPRO
QCPP14PTF	QUICK CONNECT IN-LINE PLUG-1/4 POLY TUBE FITTING-GREY
QCPP14PTF-S	QUICK CONNECT IN-LINE SOCKET-1/4 POLY TUBE FITTING-GREY
QCSS12F	SS NON CHECK 1/2 IN QUICK CONNECT COUPLER - FPT
QCSS12M	SS NON CHECK 1/2in QUICK CONNECT PLUG - MPT
QF14P	QUICK FIT-1/4 MPT X 1/4 OD TUBE-POLYPROPYLENE
QF5614	1/4in QF PUMP FITTING / G57
QFAEL1414	1/4IN BARB X 1/4IN STEM ELBOW
QFAEL3814	3/8IN BARB X 1/4IN STEM ELBOW
QFBH14	BULKHEAD 1/4in TUBE POLYPROPYLENE
QFBH38	BULKHEAD 3/8in TUBE POLYPROPYLENE
QFEL14P	FIXED ELBOW 1/4in TUBE X 1/4in MPT - POLYPROPYLENE
QFSEL14	PLUG-IN ELBOW 1/4in TUBE X 1/4in TUBE - POLYPROPYLENE
QFSEL3814	PLUG-IN ELBOW 3/8IN TUBE X 1/4IN TUBE
R25	AIR REGULATOR - 1/4ft TWO PORT 1/8ft TWO PORT - INCLUDES FILTER AND BOWL
S10241	10-24 X 1 IN PAN HEAD MACHINE SCREW

S14201	1/4 20 Pan Head Screw - 1 inch Stainless
S142058-VS	1/4-20 X 5/8 PHIL TRUSS MACHINE SCREW 18-8 W/#516 VIBRASEAL ORANGE PATCH
SM420MM	M4 X 0.7MM X 20MM LONG SCREW-SS
SSA12	STAINLESS ADAPTOR 1/2 MPT X 1/2 FPT
SSA14	STAINLESS ADAPTOR 1/4 MPT X 1/4 FPT
SSAXLE581858	SS AXLE .625 DIA x 18.62 IN
SSC38	STAINLESS SCREW BAND CLAMP FOR 3/8 IN HOSE
SSP12	STAINLESS STEEL AXLE PLATE - 2.5 inch X 1 inch - 2 HOLE
SSST	SCREEN DISC .687 DIA. 10 X 10 MESH @ .020 DIA. 300 SERIES S.S.
ST5030	SPRAY TIP-50 DEGREE-3.0 GPM
STR38-IL	IN LINE STRAINER-3/8 BARB-EPDM GSKT-20 MESH SS
TANK-15N-C	15 GALLON CONCENTRATE TANK NATURAL IN COLOR
TANK-15NC-ACBRKT	SS BRACKET FOR AIR COMPRESSOR ON TANK-15NC
TANK-15NC-HRBRKT	12G SS BRACKET FOR HOSE REEL ON TANK-15NC
TW916	1/2 INT TOOTH L/W 410SS
W15	NONMARKING WHEEL FOR PORTABLE UNITS
WAAD-.75	WADDING FOR PUMP-UP FOAMER-3/4 IN DIA.
WR-GFI-A	LEVITON GFI PLUG W/ 8 FT 6 IN CORD ASSEMBLED